



FESTIVAL

**GALA CHORUSES
DENVER • 2016**

The logo features a stylized mountain range with three peaks in orange, blue, and green. Below the mountains, the word "FESTIVAL" is written in a large, green, sans-serif font, with a green musical staff and notes integrated into the letters. Below "FESTIVAL", the text "GALA CHORUSES" and "DENVER • 2016" is written in a smaller, blue, sans-serif font.



Introductions

Robin Godfrey, Executive Director
ExecutiveDirector@GalaChoruses.org

Jane Ramseyer Miller, Artistic Director
AD@GalaChoruses.org

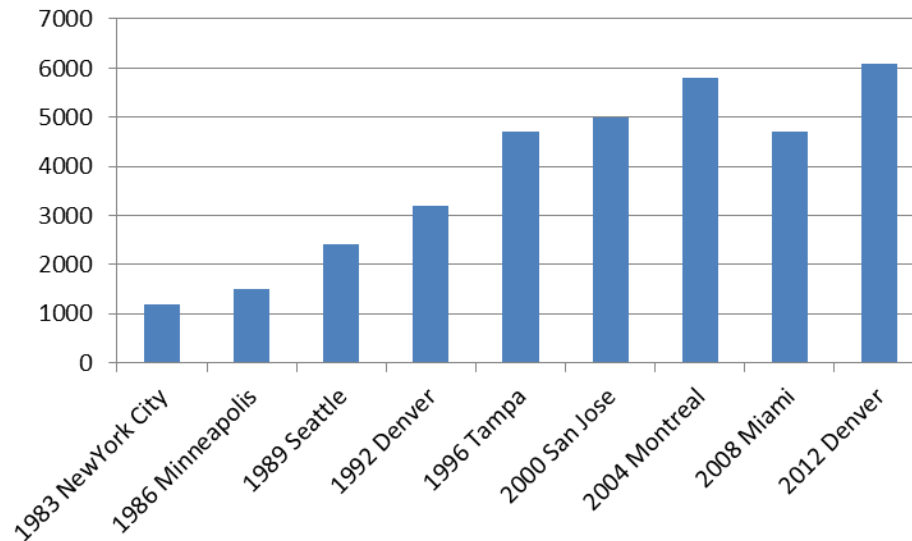

GALA Festival 2016, held July 2-6 in Denver, will be the 10th GALA Festival

Expecting over 6,000 singers to attend representing 150-160 choruses and ensembles.



The Denver Performing Arts Complex

One of the largest arts complexes in the world featuring 10 performance spaces connected by an 80-foot-tall glass roof.

- Ellie Caulkins Opera House
- Boettcher Concert Hall
- Temple Hoyne Buell Theatre
- Stage Theater & Seawell Ballroom



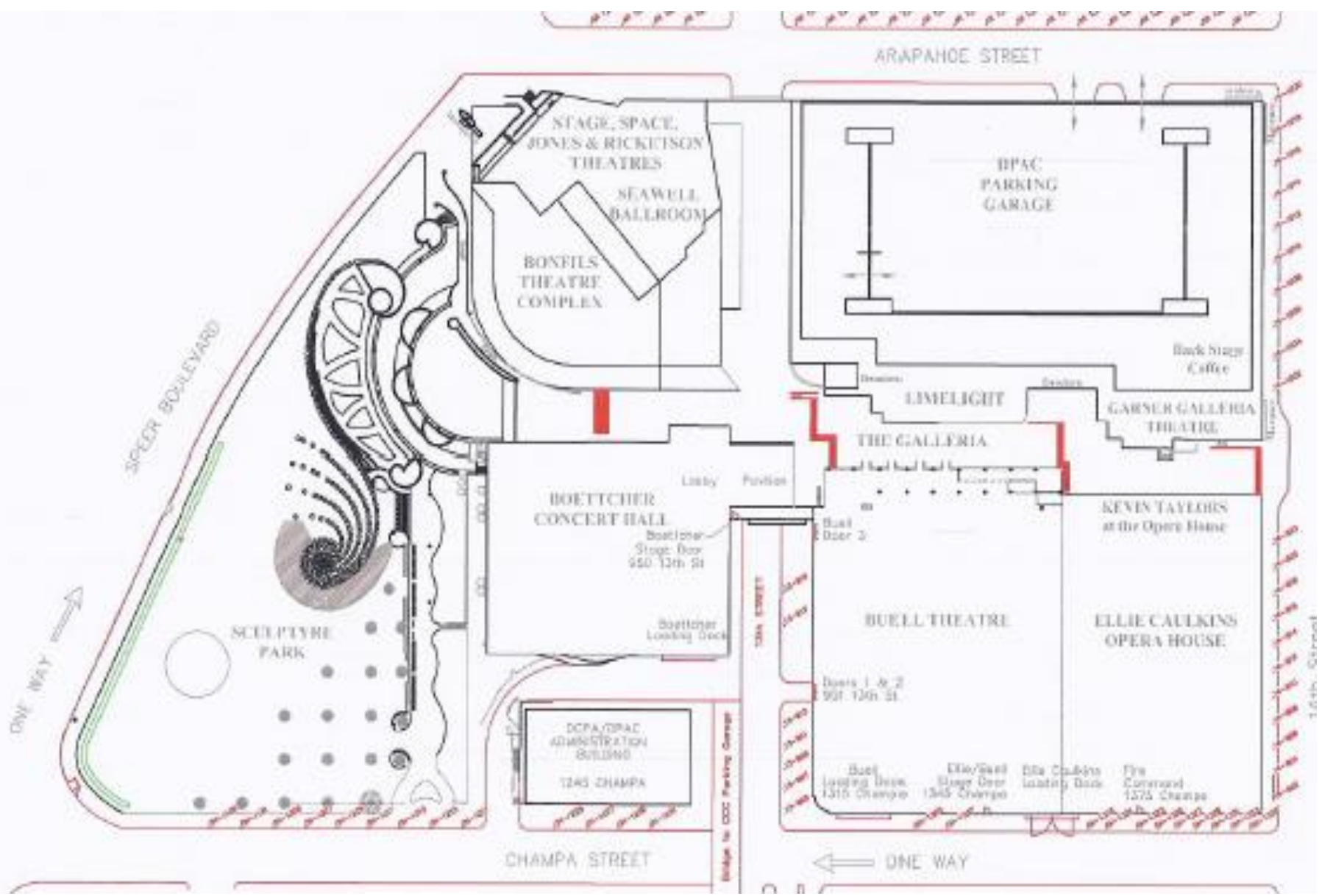



Boettcher Concert Hall – 2,700 Seats

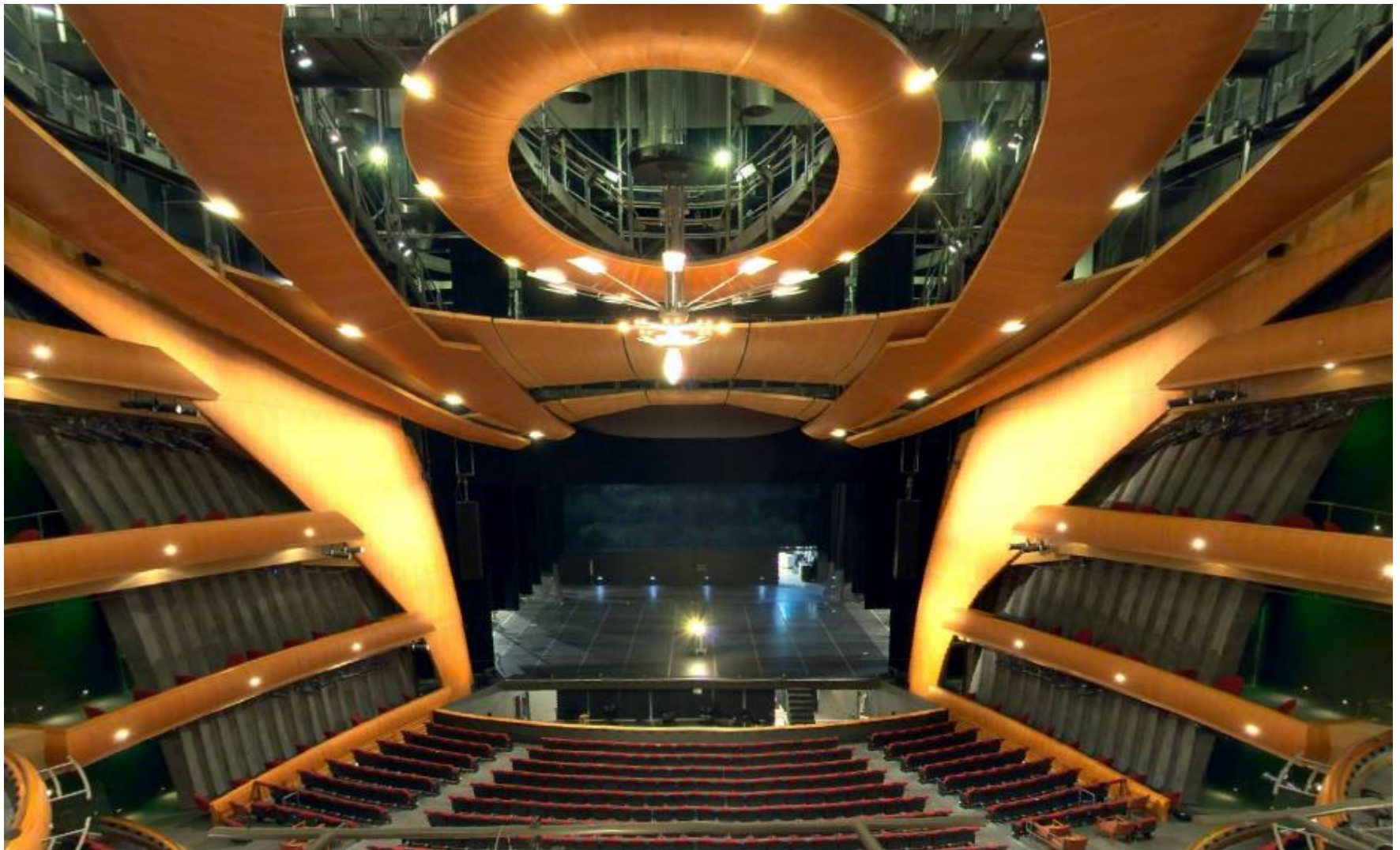

Ellie Caulkins Opera House – 2,225 seats



SCENES

Buell Theater – 2,884 seats



**Stage Theater – 750 seats
Ensemble Showcase**



**Seawell Ballroom –
900 seats
Late-night Ensemble Concerts**



Festival 2016 Performance Schedule Example

	Sat, July 2				Sun, July 3				Mon, July 4				Seawall Ballroom	Tues, July 5				Wed, July 6				
	Boettcher	Buell	Ellie	Stage	Boettcher	Buell	Ellie	Stage	Boettcher	Buell	Ellie	Stage		Boettcher	Buell	Ellie	Stage	Boettcher	Buell	Ellie	Stage	
8:00 AM																						
8:30 AM																						
9:00 AM																						
9:30 AM																						
10:00 AM						Coffee Concert				Coffee Concert					Coffee Concert				Coffee Concert			
10:30 AM																						
11:00 AM							Coffee Concert			Coffee Concert						Coffee Concert				Coffee Concert		
11:30 AM															Tech		Coffee Concert					
12:00 PM																						
12:30 PM						Concert Block	Concert Block	Concert Block		Concert Block	Concert Block	Concert Block			Concert Block	Concert Block	Concert Block		Concert Block	Concert Block	Concert Block	
1:00 PM																						
1:30 PM																						
2:00 PM																						
2:30 PM																						
3:00 PM								Youth Concert														
3:30 PM																						
4:00 PM						Concert Block	Concert Block	Concert Block		Concert Block	Concert Block	Concert Block			Concert Block	Concert Block	Concert Block		Concert Block	Concert Block	Concert Block	
4:30 PM																						
5:00 PM																						
5:30 PM																						
6:00 PM																						
6:30 PM																						
7:00 PM																						
7:30 PM	Opening Concert				Mixed Chorus Singin' in the Round	Naked Man 20th Anniversary		Celebrating Women	Exploring Spirituality													
8:00 PM			Ensemble Concerts																			
8:30 PM																						
9:00 PM	Opening Concert			Late Night Ensemble			African American Whatever	Late Night Ensemble		I Am Harvey Milk	Blockbuster			Blockbuster	Blockbuster							
9:30 PM																						
10:00 PM																						
10:30 PM																						
11:00 PM												Late Night Ensemble									Late Night Ensemble	Closing Ceremonies & Party!

The schedule shown above is intended to be an example of how the festival generally lays out but not a precise schedule of what will be happening when and where.



July 2 Festival Opening Events

- **Opening concerts**
- **Ensemble Festival** in the Seawell Ballroom & Stage Theater
- **Colorado chorus' welcome** events in the Galleria
- **Food and drink vendors** in the Galleria and Sculpture Garden
- **Flash Mob Event** at Denver Pavilion





Concert Block Overview



- 30 minute set: entrance/exit time and all movement/transitions
- Movement of piano or instrumentalist will come out of your set time
- Stage set-up: grand piano, music stand and risers: 4 ft deep, 5 risers high (4 risers in Boettcher plus optional use of the parquet).

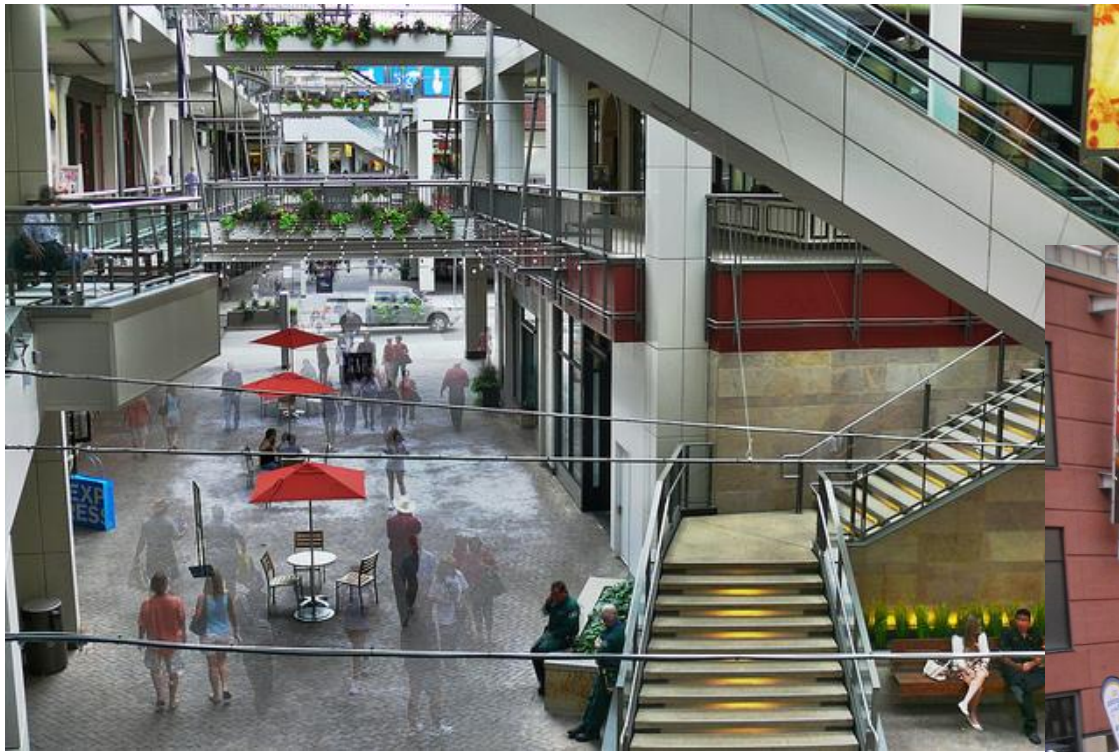

GALA Flash Mob - Denver Pavilions
500-1000 singers



Morning Coffee Concerts

- Limited number of 50 minute performance sets
- Performed in primary concert halls
- Can accommodate more complicated staging or instrumentation
- Chorus is responsible for any incremental backstage labor, sound, lighting costs incurred

If selected for a Coffee Concert this performance counts as your chorus' Festival performance.

Coffee Concert Timeline

Sept 2014	Coffee Concert application process is open. Application and details on website.
Jan 31, 2015	Coffee Concert applications due
Feb/Mar 2015	Committee reviews Coffee Concert applications
May 2015	Coffee concert participants selected and notified



Coffee Concert Selection

The **application and audition** for a Coffee Concert includes:

- Description of the proposed program, repertoire, performing forces and general technical needs.
- Choral score or a description of the work to be commissioned.
- Three (3) representative song recordings – not to exceed a total of 15 minutes
- Three (3) representative concert programs

Criteria: applications that demonstrate

- unique and creative programming concepts
- high artistic and musical quality
- the ability of the chorus to successfully perform the proposed program based on previous programming.
- connection to the mission of GALA Choruses



Evening Blockbuster Concerts

- Exploring Music & Gender
- Show Tune Showdown
- Exploring Spirituality
- Youth Invasion
- Classical Music Sing- along
- Communities of Color, Multi-Cultural Concert
- I Am Harvey Milk
- Celebrating Women/ Mixed Chorus Sing- along/
TTBB Naked Man anniversary performance





Additional Performance Options

- **Flash mob** performance in downtown Denver
- **Outdoor stage** and **Photo Risers**
- Ensembles in **Show Tune Showdown**
- **Blockbuster** concerts
- **Opening concert**
- **Celebrating Women** (SSAA)
- **Mixed Chorus Singin' in the Round** (SATB)
- **I Am Harvey Milk** (TTBB)



Collaborations and Shared Concert Sets

Partner with a chorus in your community

...from another province or state

...or, from across the world!





Festival Workshops

A variety of workshops will be held each morning for registered delegates.

- **Singer workshops:** vocal-focused training, musical issues
- **Artistic Directors:** programming, conducting
- Workshops for **non-singing board members**
- Workshops for **chorus volunteers** and **administrative staff**

Start now to **encourage your non-singing volunteers** to join your chorus for the Festival experience!



GALA Youth Choruses

- Youth Chorus performances
- Shared housing
- Workshops and guest presenters
- Youth Invasion Blockbuster Concert
- Social activities
- Youth dance with queer youth from Denver



Highlights for Women at Festival 2016

- Women's Chorus **performance evening in Boulder, CO**
- Roma **Commissioning Project** Performance
- **Celebrating Women Concert**
- **Women's party** in the Stage Theatre lobby
- Festival women **late-night dance**
- Morning **workshops** feature workshops for women and women's voices

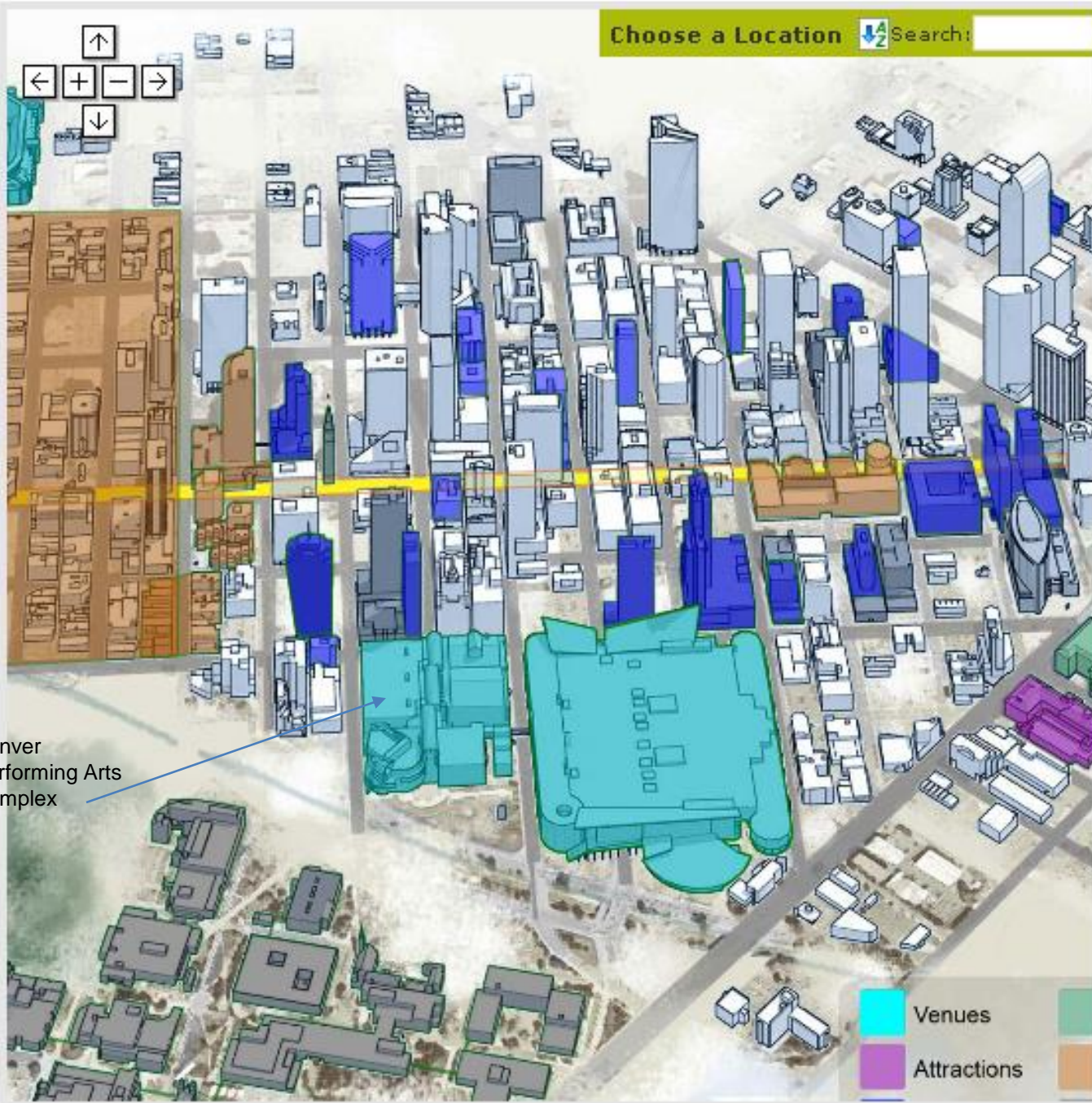

Denver
Performing Arts
Complex

Festival Village Layout



Hotel	Rate	Blocks to DPAC
1 Comfort Inn Downtown	\$109.00	8 Blocks
2 Courtyard by Marriott Downtown	\$149.00	2 Blocks
3 The Curtis, a DoubleTree Hotel by Hilton	\$159.00	1 Block
4 Embassy Suites Denver Downtown at the Convention Center	\$199.00	1 Block
5 Four Seasons Hotel Denver	\$209.00	1 Block
6 Grand Hyatt Denver	\$164.00	6 Blocks
7 Hampton Inn & Suites Denver/Downtown – Convention Center	\$179.00	3 Blocks
8 Hilton Garden Inn Downtown Denver	\$179.00	3 Blocks
9 Homewood Suites Denver/Downtown – Convention Center	\$197.00	3 Blocks
10 Hyatt Regency at Colorado Convention Center	\$169.00	1 Block
11 Magnolia Hotel Denver	\$149.00	3 Blocks
12 Renaissance Denver Downtown Hotel (Opening January 2014)	\$209.00	3 Blocks



Delegate Registration	
Early	225
Regular	265
Late	299
Youth/Disabled	150
Senior Early	165
Senior Regular	175
Senior Late	185



GALA Festival 2016 Estimated Costs

		Chorus Name	
Chorus Registration	\$ 350.00	15 Min	\$225
Ensemble Registration	\$ 225.00	30 Min	\$350
		60 Min	\$750
Director Registration	\$ 225.00	Early	\$225
Accomp Registration	\$ 225.00	Regular	\$265
Ensemble Director	\$ 225.00	Late	\$299
Staff flight & travel	\$ 1,350.00	Flight - plus \$20-60 for local travel	
Staff Housing estimate	\$ 2,135.00	See hotel estimates below	
Staff food per diem	\$ 800.00	See meal estimates below	
Rehearsal Space	\$ 120.00		
Instrumentalists	\$ -		
Additional tech fees	\$ -	For choruses selected for a 60-min Special Concert	
ASL interpreter	\$ 100.00	<i>estimate</i>	
Banner	\$ 150.00		
Other			
Chorus Costs	\$5,905.00		



Delegates

Registration	\$ 225.00	Early	\$225					
		Regular	\$265					
		Late	\$299					
Flight & Travel	\$ 450.00	<i>(example rate - plus \$20-60 for local travel)</i>						
Hotel	\$ 254.25	<i>(example, quad room for five nights)</i>						
		Room	Tax	Cost of \$180 room per night + 13% taxes				
		180	1.13					
		Nights	Room Cost	Each for 2	Each for 3	Each for 4		
		1	\$ 203.40	\$ 101.70	\$ 67.80	\$ 50.85		
		2	\$ 406.80	\$ 203.40	\$ 135.60	\$101.70		
		3	\$ 610.20	\$ 305.10	\$ 203.40	\$152.55		
		4	\$ 813.60	\$ 406.80	\$ 271.20	\$203.40		
		5	\$ 1,017.00	\$ 508.50	\$ 339.00	\$254.25		
		6	\$ 1,220.40	\$ 610.20	\$ 406.80	\$305.10		
		7	\$ 1,423.80	\$ 711.90	\$ 474.60	\$355.95		
Food	\$ 200.00	Cheap	\$25/day					
		Middle	\$40/day					
		Expensive	\$80/day					
Delegate Costs	\$1,129.25							



Chorus Member Scholarships

In order to make Festival as accessible as possible, GALA Choruses is offering one waived registration for every 20 delegates registered from your chorus.

We welcome any choruses that have raised sufficient funds for their singers to attend Festival to “donate” their free registrations to a chorus with fewer resources.



Festival Countdown



September 2014	Coffee Concert application process opens
January 31, 2015	Coffee Concert applications due
March 2015	Chorus/Ensemble Registration Opens including requests for Blockbuster performance participation
May 2015	Coffee concert participants selected and notified Early delegate registration opens – web registration only
July 1 2015	Chorus Registration Deadline
Fall 2015	Early delegate registration ends
November 2015	Chorus performance schedule announced
January 2016	Festival housing registration opens
April 2016	Music Program , recording and rehearsal space requests due
April 2016	Performance introductions & Production worksheets due
July 2-6, 2016	GALA Festival 2016



Festival Communication

Webinars: Introduction to Festival, programming for ADs, housing info

GALA Website: for updated Festival info and registration

Festival Budget Spreadsheet: on website

Fundraising Tips and Tools for Festival: on website

E-blasts



If you have questions you may contact:

Robin Godfrey, Executive Director

ExecutiveDirector@GalaChoruses.org

Jane Ramseyer Miller, Artistic Director

for question about Festival programming

AD@GalaChoruses.org

